



PV Connector



DEGSON website



LINKEDIN



# Photovoltaic Connector

PV 23-E01



DEGSON ELECTRICAL CO., LTD.

Add : No.1585.Xiaolin Road.Cixi.Ningbo China

P.C. : 315321

www.degson.com

The catalog is for reference purpose only and details are base on company's specifications

Tel : +86-574-63510770

E-mail : sale@degson.com

## BRIEF INTRODUCTION

**01** Founded in 1990, DEGSON is a global solution provider of electrical, electronic and industrial connectors. As a National High-tech enterprise, DEGSON owns the UL and VDE certified laboratory. The company achieved ISO9001, ISO14001, ISO80079-34, ISO/TS22163 and IATF16949 management system certifications.

**02** DEGSON is engaged in supplying highly reliable and durable products to serve global customers. The company has a market-leading capability of mould processing, automatic manufacturing and advanced testing. DEGSON has the complete engineering ability to support global customers with the professional customization solution and value-added service.

**03** DEGSON products are widely recognized in China, the USA, Germany, the UK, Italy, Spain, Turkey, Japan, South Korea, Singapore, etc. totally hundred countries and regions. DEGSON supply high quality products and provide professional services globally in the industry sectors likely industrial automation, instrument, electric power, railway, marine and offshore, new energy, elevator, lighting, security, machinery, etc. The company won the recognition from partners among Fortune 500 and industry leading enterprises.

**04** Based on the business philosophy of “pragmatic innovation, responsibility, integrity, harmonious development, regulation and win-win”, DEGSON continuously integrates professional technical resources, R&D innovation, product manufacturing and technology application capabilities. Relying on global sales network, DEGSON aims to supply series of multiple varieties of high-quality products and services. We provide global customers with professional and quick connected application solutions, help customers continue to create value. DEGSON is making contributions to creating a smart and interconnected world.



## DEGSON Global Production Base and R&D Center



DEGSON products are very popular more than 100 countries and areas.



## First UL & VDE Certified Laboratory in Asia

### Strategic cooperation with UL and VDE



① The general manager of UL global energy & technology division visit our company



② Sven Ohrke, President of VDE global services, discusses mutual strategic cooperation in DEGSON



③ VDE Laboratory Accreditation: In July 2010, VDE issued the "VDE Authorized Laboratory" certificate to DEGSON laboratory.  
 UL laboratory accreditation: UL formally issued "UL WTDP" certificate to DEGSON in March 2013.  
 In April, 2016, UL-CTDP.  
 In December, 2016, VDE-TDAP.  
 In January, 2017, Pass IRIS system audit.

# CONTENTS

- PV Connector .....2-3
- PV 4-in-1 Connector .....4-5
- DC Distributor.....6
- DC Connector.....7
- DC Fuse Connector .....8-9
- Wifi Communication Box.....10-11
- Round Seat RJ45 Connector..... 12-13
- Dual RJ45 Connector ..... 14-15
- Square Seat RJ45 Connector .....16-18
- 18 Pin Communication Connector.....19-20
- 8 Pin Communication Connector.....21-22
- Communication & Power Integration Box .....23-28
- 5 Pin Power Connector .....19-30
- 10 Pin Power Connector .....31-32

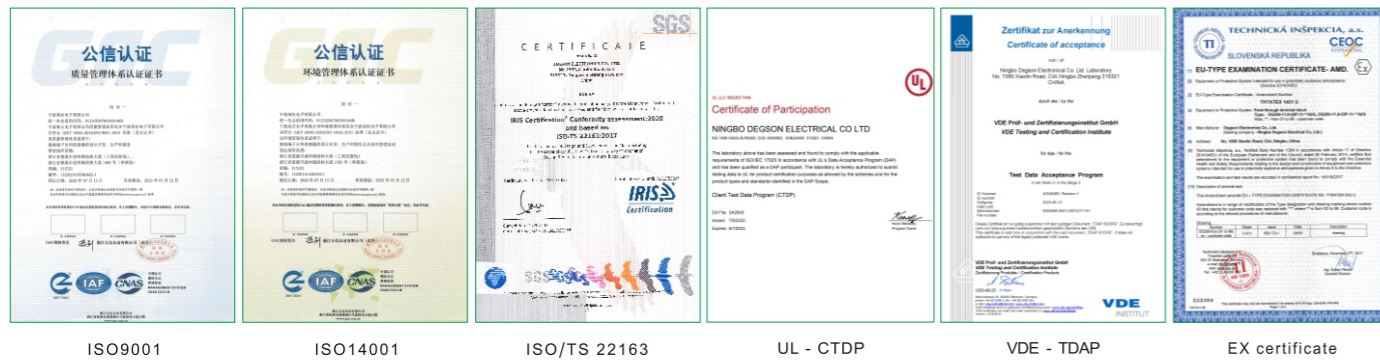

UL Certificates:10,Covering 4000+Products VDE Certificates:178,Covering 3000+Products TUV certificate EAC certificate CE certificate European invention patent

The photovoltaic connector is a key component that connects the modules, bushboxes, controllers and inverters in the photovoltaic power generation system. Degson offers connector products for photovoltaic solutions ranging from photovoltaic panels, DC wiring systems, inverters to AC connection systems for grid-connected applications.



DEGSON offers connector products for photovoltaic solutions ranging from photovoltaic panels, DC wiring systems, inverters to AC connection systems for grid-connected applications.

- Ac-dc connection technology for device connection
- DC connection technology for field wiring
- Connection technology for signal and data transmission

## PV Connector - Cable End Male/Female Plug

### Scope of application

Application in photovoltaic equipment

### Product function characteristics

- Silver-plated contacts bring high electrical conductivity.
- Secure locking system.
- Anti-touch protection design.



Cable end male plug



Cable end female plug

### Technical Data

Rated current	30A	Connection mode	Crimping
Rated voltage	1000V	Material	PPO
Line diameter range	2.5~6.0	Contact parts	Copper plated with silver
Flame retardant rating	UL94V-0	Protection level	IP67
Operating temperature	-40°C ~ +85°C	Environmental protection	Meet RoHS
—	—	—	—

### Dimension Figure



## PV Connector - Board End Male/Female Socket

### Scope of application

Application in photovoltaic equipment

### Product function characteristics

- Silver-plated contacts bring high electrical conductivity.
- Secure locking system.
- Anti-touch protection design.



Board end male socket



Plate end female socket

### Technical Data

Rated current	30A	Connection mode	Crimping
Rated voltage	1000V	Material	PPO
Line diameter range	2.5~6.0	Contact parts	Copper plated with silver
Flame retardant rating	UL94V-0	Protection level	IP67
Operating temperature	-40°C ~ +85°C	Environmental protection	Meet RoHS
—	—	—	—

### Dimension Figure



## (Custom) PV 4-in-1 Connector - Plug

### Scope of application

Applied to photovoltaic, energy storage equipment connection

### Product function characteristics

- Quick insertion and removal.
- Moderate inserting and pulling force.
- The shell is provided with an installation identification mark.
- Easy maintenance.



Positive and negative plug

### Technical Data

Rated current	40A	Connection mode	Crimping
Rated voltage	1500V	Salt spray	48H
Insulation resistance	≥100MΩ	Voltage resistance	8KV
Flame retardant rating	UL94V-0	Mechanical life	≥100
Operating temperature	-40°C ~ +125°C	Environmental	RoHS compliant
Protection level	IP68	Contact impedance	≤4.5mΩ

### Dimension Figure

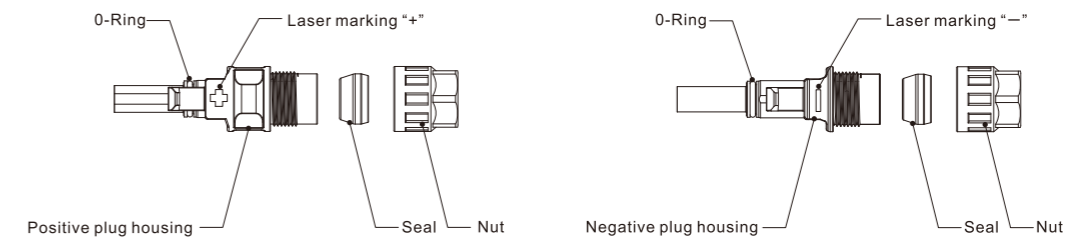

## (Custom) PV 4-in-1 Connector - Socket

### Scope of application

Application in photovoltaic equipment

### Product function characteristics

- Quick insertion and removal.
- Moderate inserting and pulling force.
- Four-in-one integration saves space.
- After insertion and removal in place, there is visual and auditory feedback.



Socket

### Technical Data

Rated current	40A	Connection mode	PCB
Rated voltage	1500V	Salt spray	48H
Insulation resistance	≥100MΩ	Voltage resistance	8KV
Flame retardant rating	UL94V-0	Mechanical life	100
Operating temperature	-40°C ~ +125°C	Environmental	RoHS compliant
Protection level	IP68	Contact impedance	≤4.5mΩ

### Dimension Figure

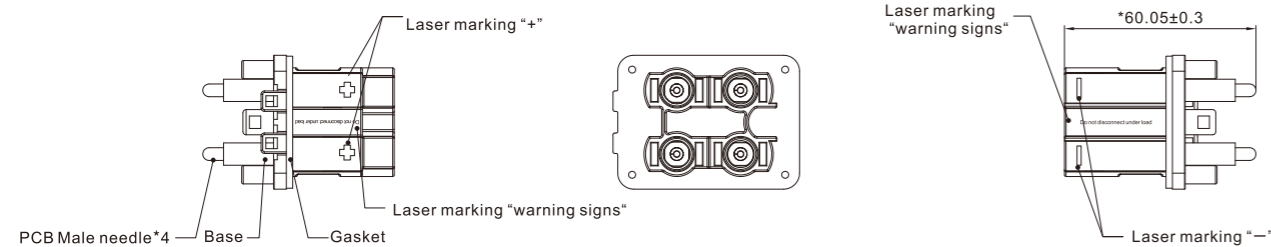

## (Custom) DC Distributor

### Scope of application

Applied to photovoltaic, energy storage equipment connection

### Product function characteristics

- Quick insertion and removal.
- Moderate inserting and pulling force.
- The shell is provided with an installation identification mark.
- Easy maintenance.



DC distributor

### Technical Data

Rated current	20/25A	Connection mode	Crimping
Rated voltage	1000/1500V	Salt Installation method	Quick-plug connection
Insulation resistance	≥100MΩ	Salt spray	48H
Flame retardant rating	UL94V-0	Voltage resistance	6800V DC
Operating temperature	-40°C ~ +85°C	Mechanical life	≥100
Protection level	IP68	Environmental	RoHS compliant

### Dimension Figure

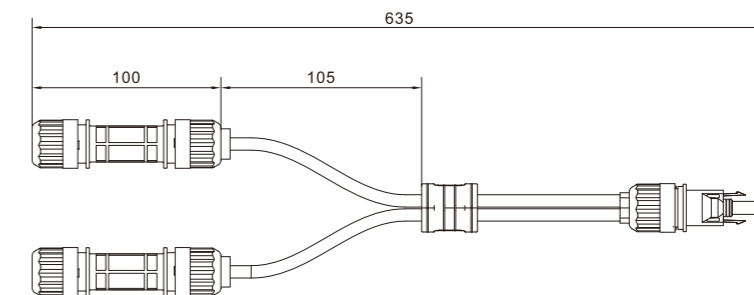

## (Custom)DC Connector

### Scope of application

Applied to photovoltaic, energy storage equipment connection

### Product function characteristics

- Quick insertion and removal.
- Moderate inserting and pulling force.
- The shell is provided with an installation identification mark.
- Easy maintenance.



DC Connector

### Technical Data

Rated current	20/25A	Connection mode	Crimping
Rated voltage	1000/1500V	Salt Installation method	Quick-plug connection
Insulation resistance	≥100MΩ	Salt spray	48H
Flame retardant rating	UL94V-0	Voltage resistance	6800V DC
Operating temperature	-40°C ~ +85°C	Mechanical life	≥100
Protection level	IP68(1m,24h)	Environmental	RoHS compliant

### Dimension Figure

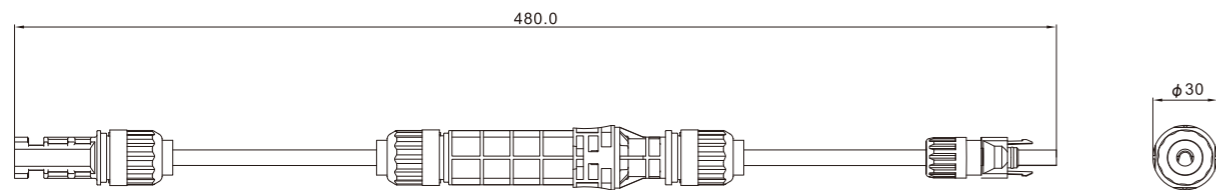

## DC Fuse Connector - Positive Pole

### Scope of application

Applied to photovoltaic, energy storage equipment connection

### Product function characteristics

- Quick insertion and removal.
- Moderate inserting and pulling force.
- The shell is provided with an installation identification mark.
- Easy maintenance.
- Solve the problem of unordered installation and unordered unlocking. The fuse is reserved in the trunk connector.



Positive

### Technical Data

Rated current	25A	Connection mode	Crimping
Rated voltage	1500V DC	Drawing force	≤15N
Insulation resistance	≥100MΩ	Salt spray	48H
Flame retardant rating	UL94V-0	Voltage resistance	6800V DC
Operating temperature	-40°C ~ +85°C	Mechanical life	≥100
Protection level	IP67/IP68	Environmental protection	RoHS compliant

### Dimension Figure

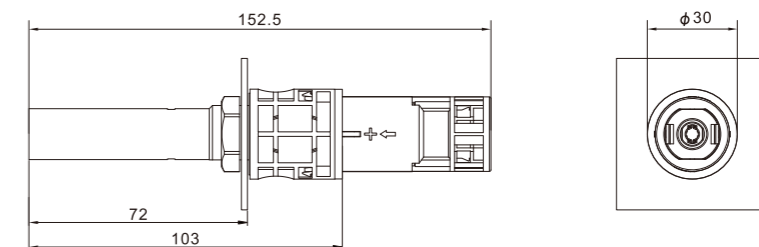

## DC Fuse Connector - Negative Pole

### Scope of application

Applied to photovoltaic, energy storage equipment connection

### Product function characteristics

- Quick insertion and removal.
- Moderate inserting and pulling force.
- The shell is provided with an installation identification mark.
- Easy maintenance.
- Solve the problem of unordered installation and unordered unlocking. The fuse is reserved in the trunk connector.



Negative

### Technical Data

Rated current	20/25A	Connection mode	Crimping
Rated voltage	1000/1500V	Salt Installation method	Quick-plug connection
Insulation resistance	≥100MΩ	Salt spray	48H
Flame retardant rating	UL94V-0	Voltage resistance	6800V DC
Operating temperature	-40°C ~ +85°C	Mechanical life	≥100
Protection level	IP68	Environmental	RoHS compliant

### Dimension Figure

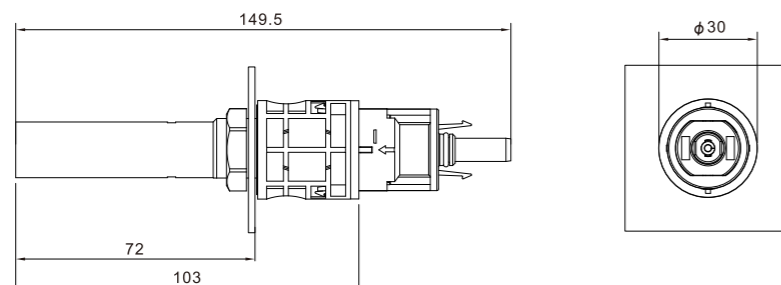

## WiFi Communication Box - Plug

### Scope of application

Applied to Used for communication signal connection

### Product function characteristics

- Quick insertion and removal.
- Moderate inserting and pulling force.
- High plugging life.
- After insertion and removal in place, there is visual and auditory feedback.



Plug

### Technical Data

Rated current	—	Connection mode	Buckle type
Rated voltage	—	Withstand voltage	500V/1min
Insulation resistance	≥100MΩ	Mechanical life	≥100
Flame retardant rating	UL94V-0	Protection level	IP65(insert/lock plate)
Operating temperature	-40°C ~ +85°C	Environmental protection	RoHS compliant
—	—	—	—

### Dimension Figure

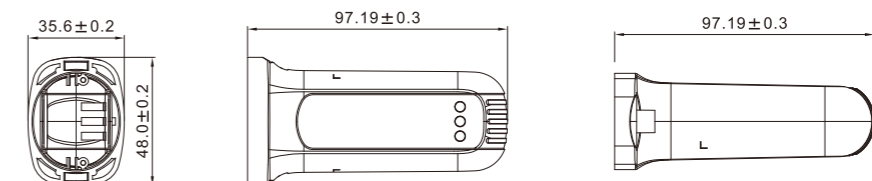



## WiFi Communication Connector - Socket

### Scope of application

Applied to Used for communication signal connection

### Product function characteristics

- Quick insertion and removal.
- Moderate inserting and pulling force.
- High plugging life.
- After insertion and removal in place, there is visual and auditory feedback.



Socket

### Technical Data

Rated current	1.5A	Connection mode	Welding
Rated voltage	150V	Salt Installation method	Quick-plug connection
Insulation resistance	≥100MΩ	Salt spray	48H
Flame retardant rating	UL94V-0	Voltage resistance	6800V DC
Operating temperature	-40°C ~ +85°C	Mechanical life	≥100
Protection level	IP68	Environmental	RoHS compliant

### Dimension Figure

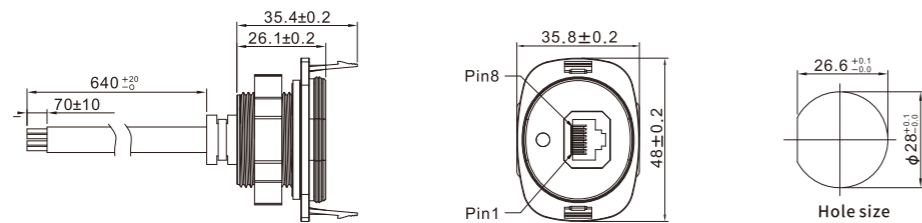

## Round Seat RJ45 Connector - Plug

### Scope of application

Applied to the communication connection of photovoltaic and energy storage equipment

### Product function characteristics

- Quick insertion and removal.
- Moderate inserting and pulling force.
- High plugging life.
- After insertion and removal in place, there is visual and auditory feedback.



Plug

### Technical Data

Rated current	1A	Connection mode	Buckle type
Rated voltage	30V	Protection level	IP67(insert/lock plate)
Insulation resistance	≥500MΩ	Withstand voltage	500V/1min
Flame retardant rating	UL94V-0	Mechanical life	≥750
Operating temperature	-40°C ~ +85°C	Environmental protection	RoHS compliant
—	—	—	—

### Dimension Figure

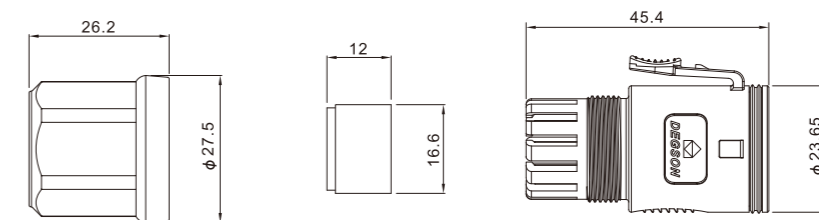

## Round Seat RJ45 Connector - Plug

### Scope of application

Applied to Used for communication signal connection

### Product function characteristics

- Quick insertion and removal.
- Moderate inserting and pulling force.
- High plugging life.
- After insertion and removal in place, there is visual and auditory feedback.

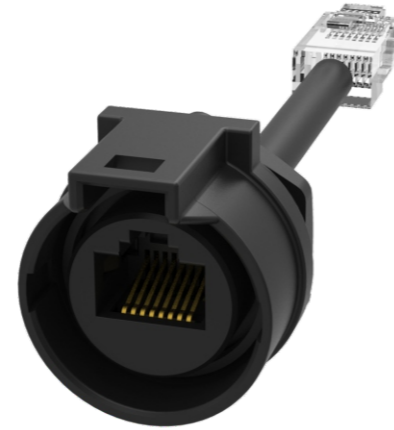

Plug

### Technical Data

Rated current	1A	Connection mode	Buckle type
Rated voltage	30V	Protection level	IP67(insert/lock plate)
Insulation resistance	≥500MΩ	Withstand voltage	500V/1min
Flame retardant rating	UL94V-0	Mechanical life	≥750
Operating temperature	-40°C ~ +85°C	Environmental protection	RoHS compliant
—	—	—	—

### Dimension Figure

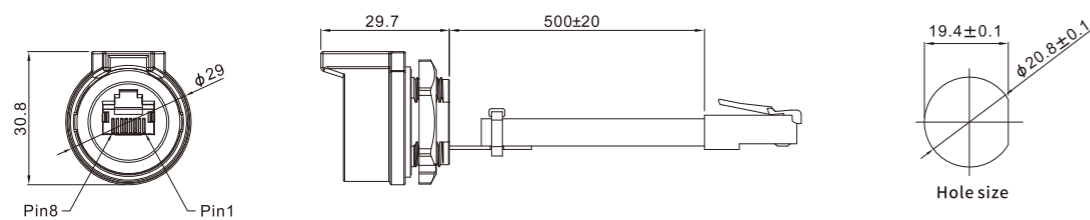

## (Custom) Dual Network Connector - Plug

### Scope of application

Applied to photovoltaic, energy storage equipment connection

### Product function characteristics

- Universal standard RJ45 PLUG can be used.
- Retain the anti-retreat function of the RJ45 PLUG buckle to prevent RJ45 disconnection.
- The client RJ45 PLUG can be installed with a cable



Positive

### Technical Data

Rated current	1A	Connection mode	Buckle type
Rated voltage	30V	Protection level	IP67(insert/lock plate)
Insulation resistance	≥500MΩ	Withstand voltage	500V/1min
Flame retardant rating	UL94V-0	Mechanical life	≥750
Operating temperature	-40°C ~ +85°C	Environmental protection	RoHS compliant
—	—	—	—

### Dimension Figure

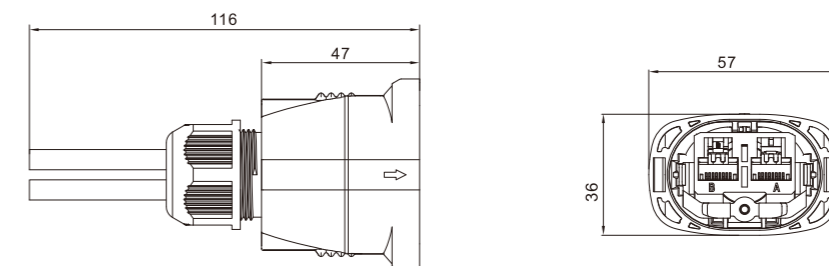

## (Custom) Dual Network Connector - Socket

### Scope of application

Applied to photovoltaic, energy storage equipment connection

### Product function characteristics

- Universal standard RJ45 PLUG can be used.
- Retain the anti-retreat function of the RJ45 PLUG buckle to prevent RJ45 disconnection.
- The client RJ45 PLUG can be installed with a cable



Socket

### Technical Data

Rated current	1A	Connection mode	Buckle type
Rated voltage	30V	Protection level	IP67(insert/lock plate)
Insulation resistance	≥500MΩ	Withstand voltage	500V/1min
Flame retardant rating	UL94V-0	Mechanical life	≥750
Operating temperature	-40°C ~ +85°C	Environmental protection	RoHS compliant
—	—	—	—

### Dimension Figure

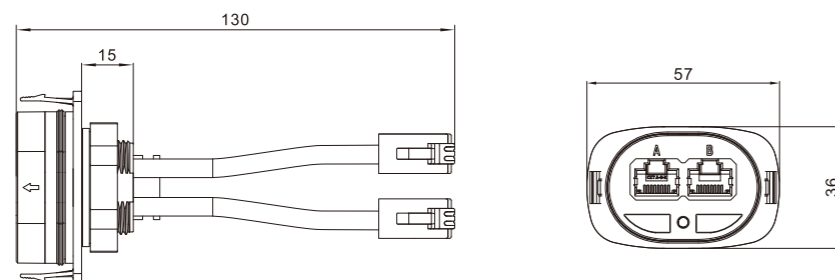

## Square Seat RJ45 Connector - Plug

### Scope of application

Applied to Used for communication signal connection

### Product function characteristics

- Can realize twice locking function, RJ45 connector safe and reliable connection.
- Moderate inserting and pulling force.
- High plugging life.
- After insertion and removal in place, there is visual and auditory feedback.



Plug

### Technical Data

Rated current	1.5A	Connection mode	Welding
Rated voltage	125V AC	Salt spray	48H
Insulation resistance	≥500MΩ	Voltage resistance	1000V AC
Flame retardant rating	UL94V-0	Mechanical life	≥750
Operating temperature	-40°C ~ +80°C	Drawing force	50N
Protection level	IP67(insert)	Environmental protection	RoHS compliant

### Dimension Figure

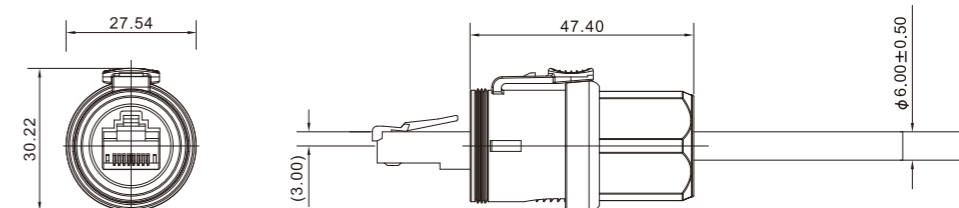

## Square Seat RJ45 Connector - Socket (one out of one)

### Scope of application

Applied to Used for communication signal connection

### Product function characteristics

- Can realize twice locking function, RJ45 connector safe and reliable connection.
- Moderate inserting and pulling force.
- High plugging life.
- After insertion and removal in place, there is visual and auditory feedback.



Socket

### Technical Data

Rated current	1.5A	Connection mode	Welding
Rated voltage	125V AC	Salt spray	48H
Insulation resistance	≥500MΩ	Voltage resistance	1000V AC
Flame retardant rating	UL94V-0	Mechanical life	≥750
Operating temperature	-40°C ~ +80°C(including temperature rise)	Drawing force	50N
Protection level	IP67(insert)	Environmental protection	RoHS compliant

### Dimension Figure

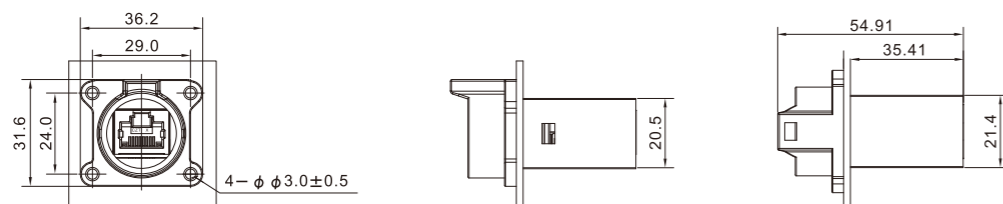

## Square Seat RJ45 Connector - Socket (1 out of 2)

### Scope of application

Applied to Used for communication signal connection

### Product function characteristics

- Can realize twice locking function, RJ45 connector safe and reliable connection.
- Moderate inserting and pulling force.
- High plugging life.
- After insertion and removal in place, there is visual and auditory feedback.



Socket

### Technical Data

Rated current	1.5A	Connection mode	Welding
Rated voltage	125V AC	Salt spray	48H
Insulation resistance	≥500MΩ	Voltage resistance	1000V AC
Flame retardant rating	UL94V-0	Mechanical life	≥750
Operating temperature	-40°C ~ +80°C(including temperature rise)	Drawing force	50N
Protection level	IP67(insert)	Environmental protection	RoHS compliant

### Dimension Figure

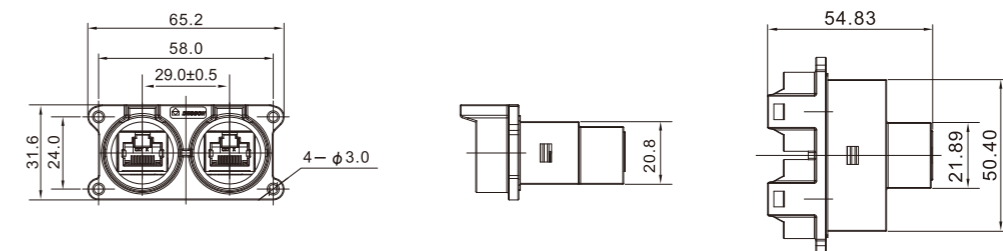

## 18 Pin Communication Connector - Plug

### Scope of application

Applied to Used for communication signal connection

### Product function characteristics

- Quick insertion and removal.
- Moderate inserting and pulling force.
- High plugging life.
- After insertion and removal in place, there is visual and auditory feedback.



Plug

### Technical Data

Rated current	1.5A	Connection mode	Buckle type
Rated voltage	165V	Material	Nylon
Insulation resistance	≥500MΩ	Voltage resistance	500V/1min
Flame retardant rating	UL94V-0	Mechanical life	≥750
Operating temperature	-40°C ~ +80°C	Drawing force	—
Protection level	IP66(insert/lock plate)	Environmental protection	RoHS compliant

### Dimension Figure

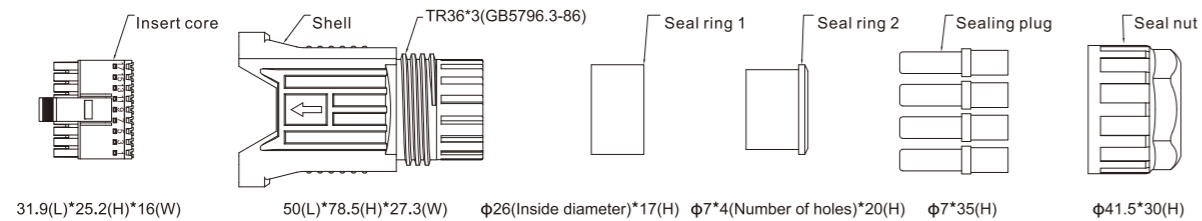

## 18 Pin Communication Connector- Socket

### Scope of application

Applied to Used for communication signal connection

### Product function characteristics

- Quick insertion and removal.
- Moderate inserting and pulling force.
- High plugging life.
- After insertion and removal in place, there is visual and auditory feedback.



Socket

### Technical Data

Rated current	1.5A	Connection mode	crimping
Rated voltage	165V	Material	PC
Insulation resistance	≥500MΩ	Voltage resistance	500V/1min
Flame retardant rating	UL94V-0	Mechanical life	≥750
Operating temperature	-40°C ~ +85°C	Drawing force	—
Protection level	IP66(insert/lock plate)	Environmental protection	RoHS compliant

### Dimension Figure

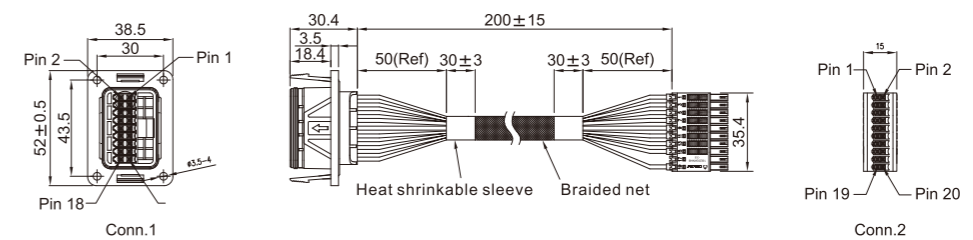

## 8 Pin Communication Connector - Plug

### Scope of application

Applied to Used for communication signal connection

### Product function characteristics

- Quick insertion and removal.
- Moderate inserting and pulling force.
- The shell is provided with an installation identification mark.
- After insertion and removal in place, there is visual and auditory feedback.



Plug

### Technical Data

Rated current	2A	Connection mode	Screw connection
Rated voltage	24V DC	Installation method	Quick-plug connection
Insulation resistance	$\geq 1000M\Omega$	Salt spray	Neutral salt spray 48h
Flame retardant rating	UL94V-0	Voltage resistance	500V/1min
Operating temperature	$-40^{\circ}\text{C} \sim +105^{\circ}\text{C}$	Mechanical life	$\geq 100$
Protection level	IP66(insert/lock plate)	Environmental protection	RoHS compliant

### Dimension Figure

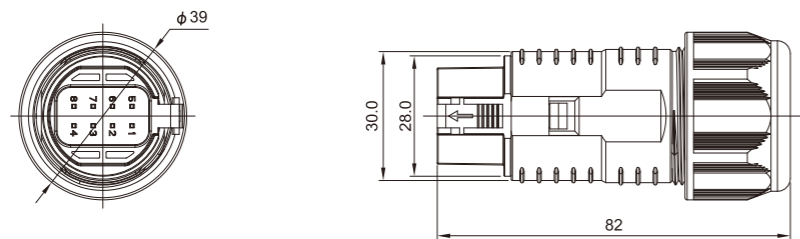

## 8 Pin Communication Connector - Socket

### Scope of application

Applied to Used for communication signal connection

### Product function characteristics

- Quick insertion and removal.
- Moderate inserting and pulling force.
- The shell is provided with an installation identification mark.
- After insertion and removal in place, there is visual and auditory feedback.



Socket

### Technical Data

Rated current	2A	Connection mode	Welded joint
Rated voltage	24V DC	Installation method	Quick-plug connection
Insulation resistance	$\geq 1000M\Omega$	Salt spray	Neutral salt spray 48h
Flame retardant rating	UL94V-0	Voltage resistance	500V/1min
Operating temperature	$-40^{\circ}\text{C} \sim +105^{\circ}\text{C}$	Mechanical life	$\geq 100$
Protection level	IP66(insert/lock plate)	Environmental protection	RoHS compliant

### Dimension Figure

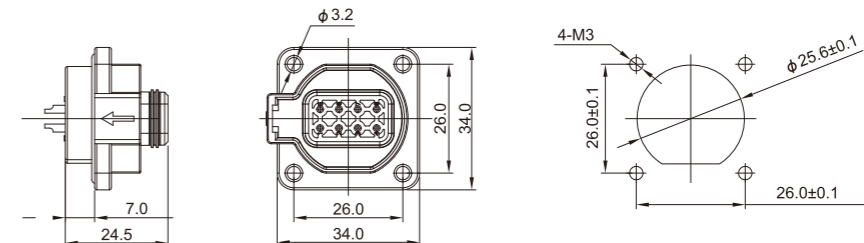

## (Custom) Communication & Power Integration Box -K04 Plug

### Scope of application

Applied to Used in communication signal equipment

### Product function characteristics

- High protection performance.
- Moderate inserting and pulling force.
- High plugging life.



K04 Plug

### Technical Data

Flame retardant rating	UL94V-0	Mechanical life	≥100
Operating temperature	-40°C ~ +85°C	Environmental	RoHS compliant
Protection level	IP66(insert/lock plate)	—	—

### Dimension Figure

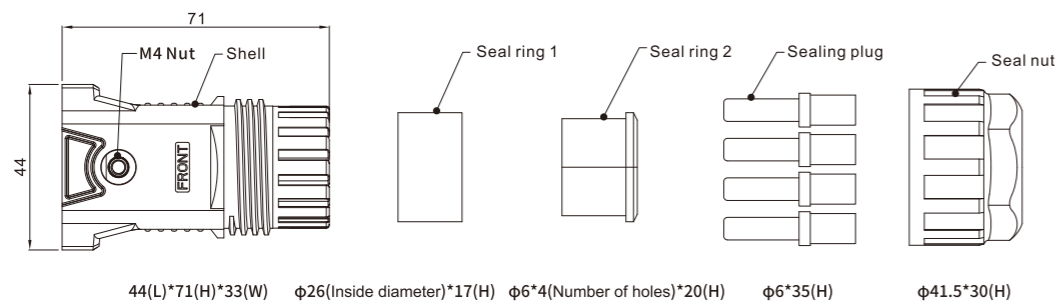

## (Custom) Communication & Power Integration Box -K04 Socket

### Scope of application

Applied to Used in communication signal equipment

### Product function characteristics

- High protection performance.
- Moderate inserting and pulling force.
- High plugging life.



K04 Socket

### Technical Data

Flame retardant rating	UL94V-0	Mechanical life	≥100
Operating temperature	-40°C ~ +85°C	Environmental	RoHS compliant
Protection level	IP66(insert/lock plate)	—	—

### Dimension Figure

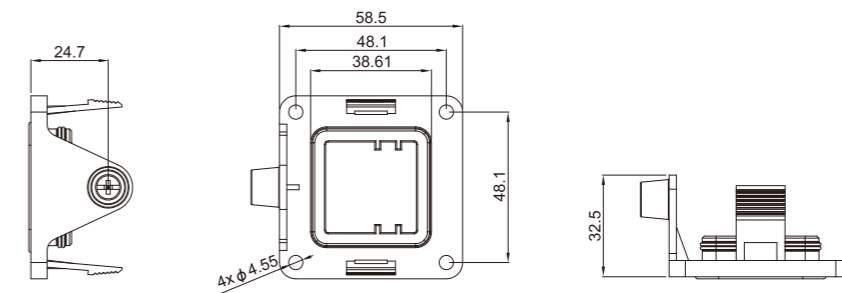

## (Custom) Communication & Power Integration Box -K05 Plug

### Scope of application

Applied to Used in communication signal equipment

### Product function characteristics

- High protection performance.
- Moderate inserting and pulling force.
- High plugging life.



K04 Plug

### Technical Data

Flame retardant rating	UL94V-0	Mechanical life	≥100
Operating temperature	-40°C ~ +85°C	Environmental	RoHS compliant
Protection level	IP66(insert/lock plate)	—	—

### Dimension Figure

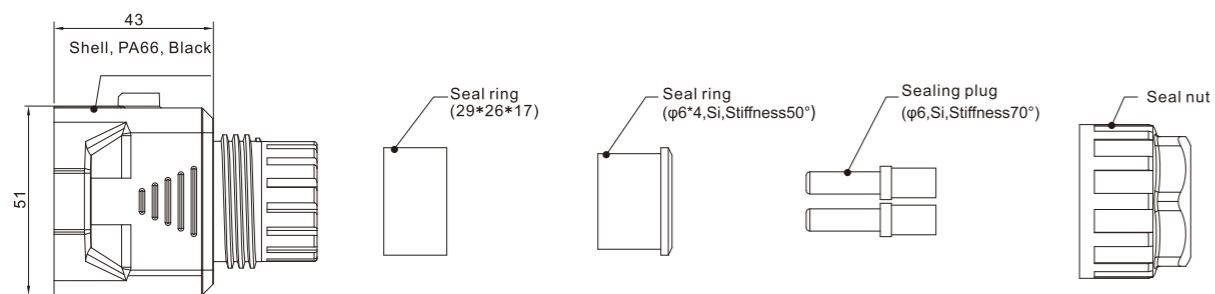

## (Custom) Communication & Power Integration Box -K05 Socket

### Scope of application

Applied to Used in communication signal equipment

### Product function characteristics

- High protection performance.
- Moderate inserting and pulling force.
- High plugging life.

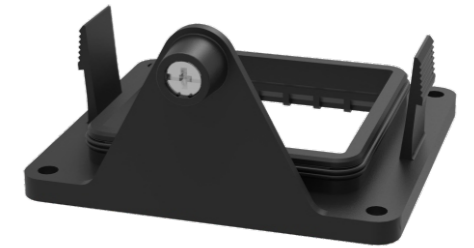

Socket

### Technical Data

Flame retardant rating	UL94V-0	Mechanical life	≥100
Operating temperature	-40°C ~ +85°C	Environmental	RoHS compliant
Protection level	IP66(insert/lock plate)	—	—

### Dimension Figure

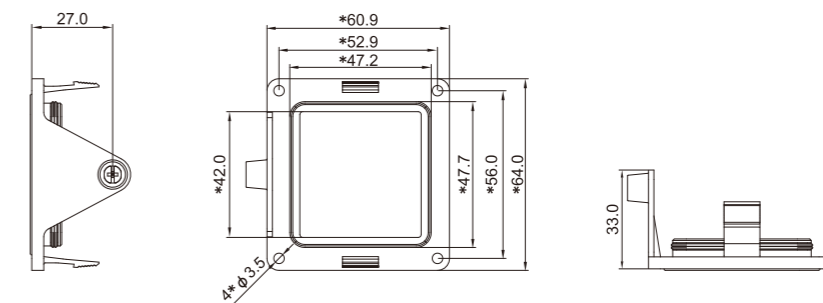



## (Custom) Communication & Power Integration Box -K06 Plug

### Scope of application

Applied to Used in communication signal equipment

### Product function characteristics

- High protection performance.
- Moderate inserting and pulling force.
- High plugging life.



K06 Plug

### Technical Data

Flame retardant rating	UL94V-0	Mechanical life	≥100
Operating temperature	-40°C ~ +85°C	Environmental	RoHS compliant
Protection level	IP66(insert/lock plate)	—	—

### Dimension Figure

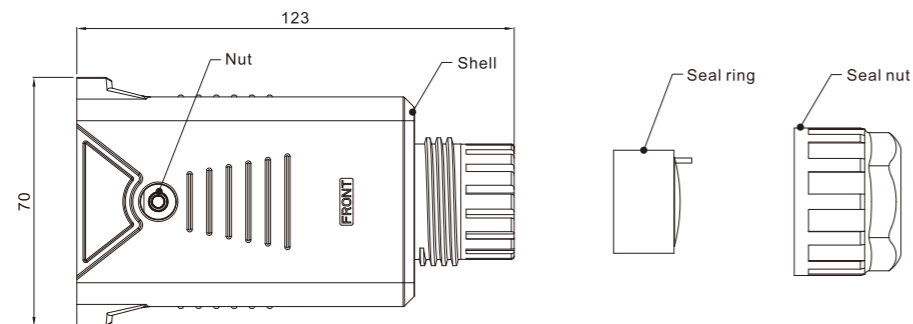

## (Custom) Communication & Power Integration Box -K06 Socket

### Scope of application

Applied to Used in communication signal equipment

### Product function characteristics

- High protection performance.
- Moderate inserting and pulling force.
- High plugging life.



K06 socket

### Technical Data

Flame retardant rating	UL94V-0	Mechanical life	≥100
Operating temperature	-40°C ~ +85°C	Environmental	RoHS compliant
Protection level	IP66(insert/lock plate)	—	—

### Dimension Figure

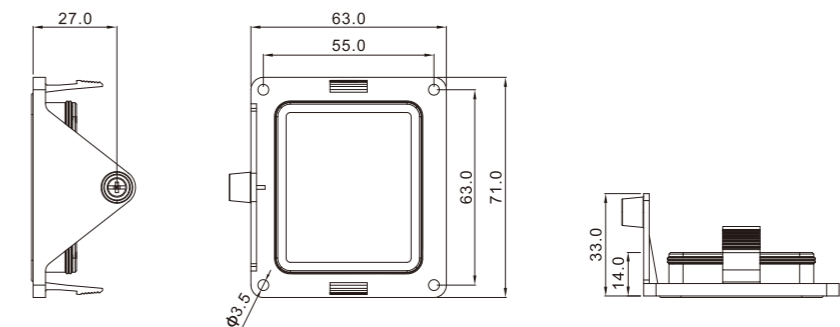

## 5 Pin Power Connector - Plug

### Scope of application

Applied to Photovoltaic power plug

### Product function characteristics

- Quick insertion and removal.
- Moderate inserting and pulling force.
- After insertion and removal in place, there is visual and auditory feedback.



Plug

### Technical Data

Rated current	65A	Connection mode	Screw connection
Rated voltage	600V	Salt spray	48H
Insulation resistance	≥100MΩ	Withstand voltage	3.31KV
Flame retardant rating	UL94V-0	Mechanical life	≥100
Operating temperature	-40°C ~ +105°C	Environmental protection	RoHS compliant
Protection level	IP66	—	—

### Dimension Figure

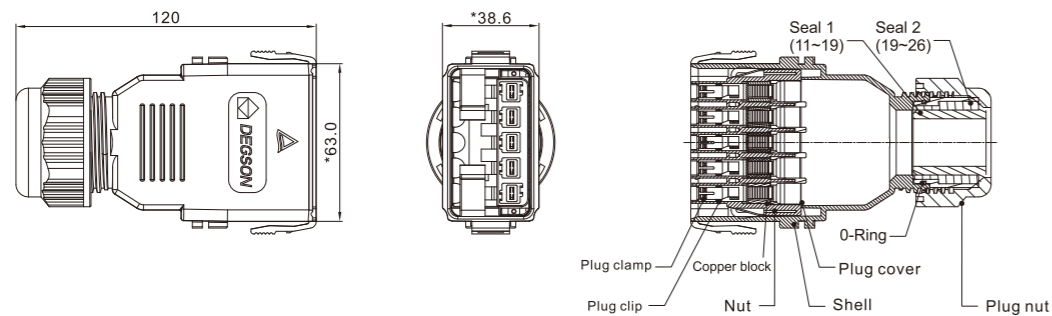

## 5 Pin Power Connector - Socket

### Scope of application

Applied to Photovoltaic power socket

### Product function characteristics

- Quick insertion and removal.
- Moderate inserting and pulling force.
- After insertion and removal in place, there is visual and auditory feedback.



Socket

### Technical Data

Rated current	65A	Connection mode	Shrapnel connection
Rated voltage	600V	Salt spray	48H
Insulation resistance	≥100MΩ	Withstand voltage	3.31KV
Flame retardant rating	UL94V-0	Mechanical life	≥100
Operating temperature	-40°C ~ +105°C	Environmental protection	RoHS compliant
Protection level	IP66	—	—

### Dimension Figure

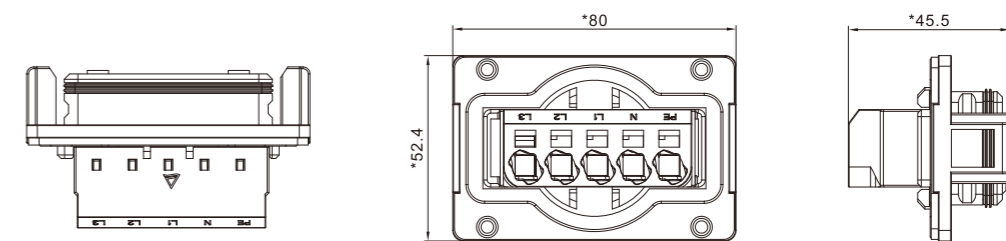

## 10 Pin Power Connector - Plug

### Scope of application

Applied to Photovoltaic power plug

### Product function characteristics

- Two-in-one function integration.
- Moderate inserting and pulling force.
- After insertion and removal in place, there is visual and auditory feedback.



Plug

### Technical Data

Rated current	75A	Connection mode	Shrapnel connection
Rated voltage	600V	Salt spray	48H
Insulation resistance	≥100MΩ	Withstand voltage	3.31KV
Flame retardant rating	UL94V-0	Mechanical life	≥100
Operating temperature	-40°C ~ +105°C	Environmental protection	RoHS compliant
Protection level	IP66	Contact impedance	≤4.5mΩ

### Dimension Figure

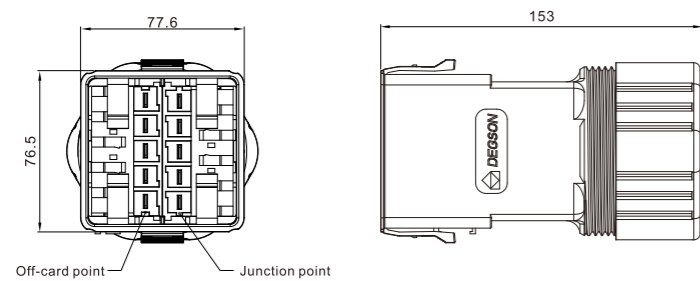

## 10 Pin Power Connector - Socket

### Scope of application

Applied to Photovoltaic power socket

### Product function characteristics

- Two-in-one function integration.
- Moderate inserting and pulling force.
- After insertion and removal in place, there is visual and auditory feedback.



Socket

### Technical Data

Rated current	75A	Connection mode	Shrapnel connection
Rated voltage	600V	Salt spray	48H
Insulation resistance	≥100MΩ	Withstand voltage	3.31KV
Flame retardant rating	UL94V-0	Mechanical life	≥100
Operating temperature	-40°C ~ +105°C	Environmental protection	RoHS compliant
Protection level	IP66	Contact impedance	≤4.5mΩ

### Dimension Figure

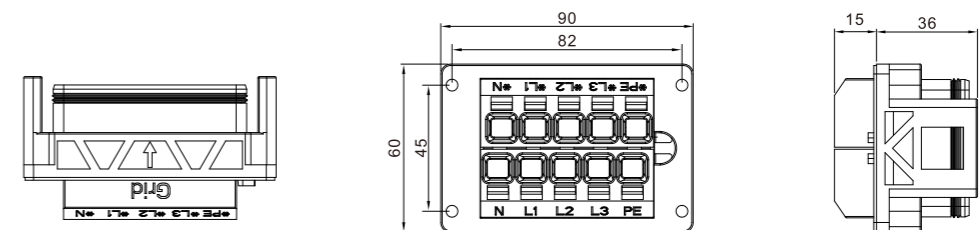



Field wiring connection



Photovoltaic inverter DC, communication, AC connection



Connect the photovoltaic panel on site



## ENVIRONMENTAL POLICY

**DEGSON** realizes system regulation without lead in 2005 and has been granted ISO14001 in 2006. All the products conform to the European ROHS requirement.

**DEGSON** realizes the importance to protect environment resources, selfconsciously meets environment protection requirements for products and regards it as the responsibility.

Thus, we have made the following environment strategic policy:

- 1.To meet customers'demands and obey the national and local laws and regulations as well as other environmental protection requirements.
- 2.Take environmental protection as one criterion for continuing development of our company. Insist on fully development of quality, benefit and environmental protection.
- 3.Fully considering the factors which will influence the environment in the processes of product development, manufacturing, material usage and waste processing, establish management system of waste in order to improve the environment of our company.
- 4.To increase the employees' consciousness of environmental protection through training and to realize the continuing improvement of environment management system and the ability of environmental protection.
- 5.To make full use of resources and to decrease consumption of material in order to save energy.
- 6.To promise to our partners and society that we will make contribution to environment protection. There is only one Earth for our humanity.
- 7.To strive for making conservation-oriented and environment-friendly products through continuous innovation and developing new materials and technology.